

HANDI-MOVE MODEL 1640

# MOBILE LIFTER

A budget friendly solution for home care



**SUREHANDS®**



- Accommodates both Handi-slings and **SUREHANDS®** Body Support
- Interchangeable control box
- Emergency down feature
- Ergonomic handle bars provide smooth steering
- Width adjustable base with low profile chassis for easy positioning
- Extended vertical lifting range from the floor onto a high bed



**SUREHANDS®**

SPECIALISTS IN INNOVATIVE AND RELIABLE LIFT & CARE SYSTEMS



# TECHNICAL SPECIFICATIONS

## CONTROL BOX (WITH BATTERIES) & CHARGER

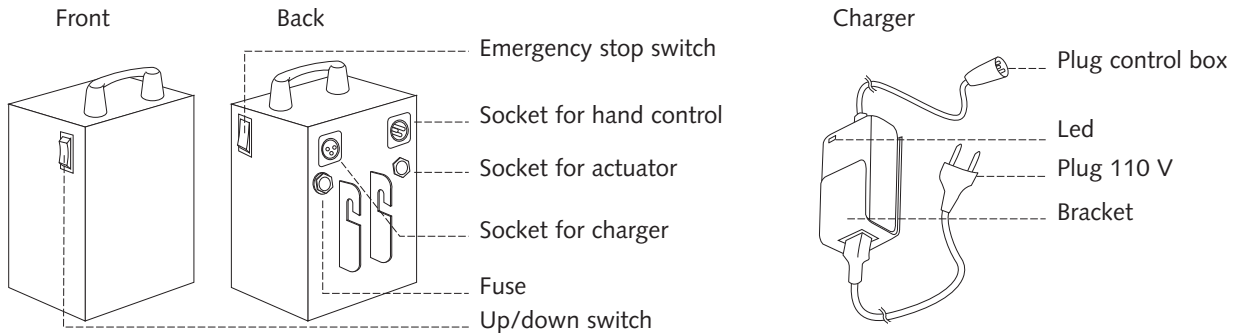

## DIMENSIONS

- A..... Overall height: ..... 2295 mm / 90.35 inch
- B..... Max. height: ..... 2085 mm / 82.09 inch
- C..... Min. height: ..... 795 mm / 31.30 inch
- D..... Mast height: ..... 1585 mm / 62.40 inch
- E..... Base height: ..... 110 mm / 4.33 inch
- F..... Caster height: ..... 100 mm / 3.94 inch
- G..... Max. base width: ..... 1190 mm / 46.85 inch
- H..... Min. base width: ..... 670 mm / 26.83 inch
- I..... Overall base length: ..... 1300 mm / 51.18 inch

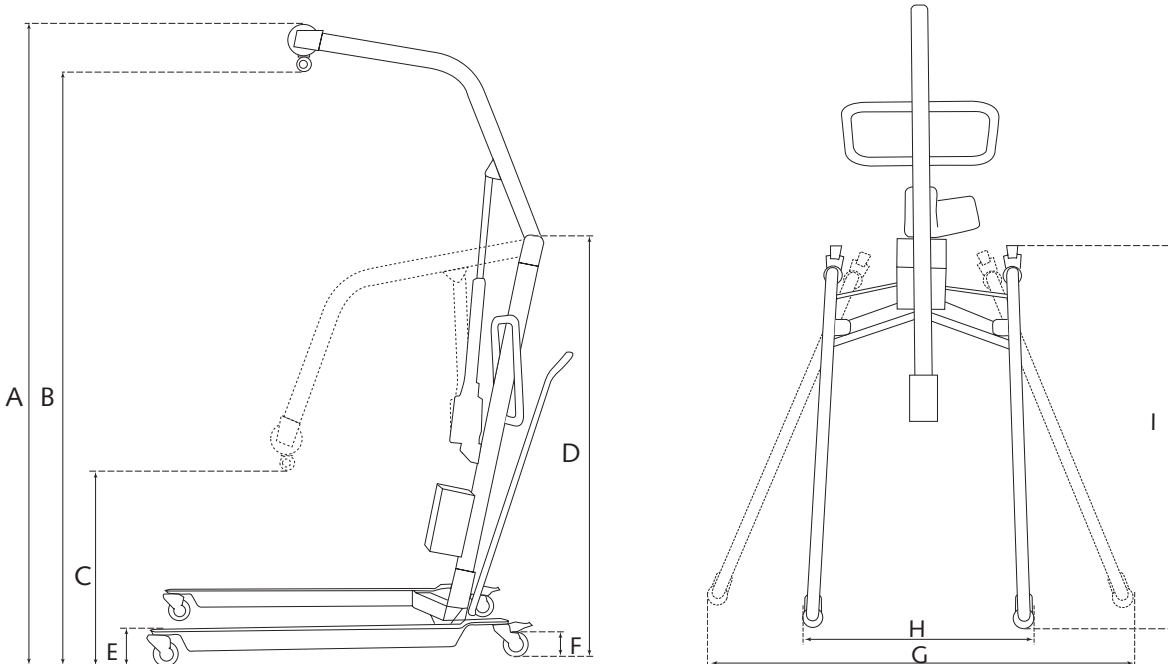

## TECHNICAL SPECIFICATIONS

- Safe working load: ..... 175 kg / 386 Lbs
- Batteries: ..... 2 x 12 V rechargeable
- Charger: ..... input 110 V AC  
..... output 24 V DC
- Emergency down feature:..... mechanical
- Number of lifts with fully charged batteries: ... 120
- Weight: Mast & boom arm: ..... 20 kg / 44.1 Lbs  
U-shaped base: ..... 21 kg / 46.3 Lbs  
Control box with batteries: ..... 7,5 kg / 16.5 Lbs  
Total: ..... 48,5 kg / 106.9 Lbs

Local Representative:

